

**TANKJET 27500 AND 27500-R TANK CLEANING NOZZLE
FEATURES AND BENEFITS**

- With rotation driven by the reactionary force of the cleaning liquid, these nozzles provide excellent cleaning and rinsing and are especially well-suited for clean-in-place (CIP) systems
- Spray angles range from 180° to 360° and can be used to clean specific areas or the entire tank interior
- Made of corrosion- and chemical-resistant PTFE fluoropolymer resin, both models provide peak performance when used with debris-free liquid and deliver greater impact than static spray balls
- 27500-R nozzles with removeable spray heads, 1/2 in. and 3/4 in. inlet connections, are also available in carbon-filled PTFE for improved thermal characteristics and higher mechanical strength. See page D4 and E4
- ATEX-certified versions available



TankJet 27500-R
tank cleaning nozzle,
see page D4 and E4

TankJet 27500
tank cleaning nozzle



SPRAY COVERAGE

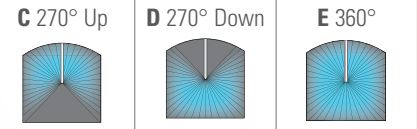
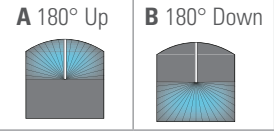

**MOUNTING
OPTIONS**

Vertical	↑	↓
Horizontal	←	→
45° Up	↖	↗
45° Down	↘	↙

SPECIFICATIONS

TankJet 27500 Tank Cleaning Nozzles	
Max. tank diameter:	25 ft. (7.6 m)
Operating principle:	Fluid-driven reactionary force
Flow rate:	125 to 391 gpm (475 to 1480 lpm)
Operating pressure:	10 to 50 psi (0.7 to 3.4 bar)
Max. temperature:	200°F (93°C)
Materials:	PTFE fluoropolymer resin
Inlet connection:	3" NPT or BSPT (F)
Optional accessories:	Strainers, recommended mesh size: 100 (150 micron) See page G2

For lances, mounting kits, adapters and more,
see page G6

DIMENSIONS AND WEIGHT

Model	Inlet Conn. in.	W in. (mm)	L in. (mm)	F (Flats) in. (mm)
27500	3	6.88 (174.6)	5.88 (149.2)	3.88 (98.4)

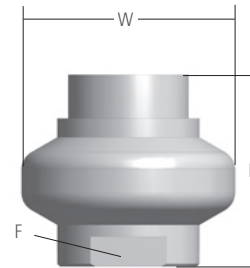

Additional sizes available:
Page D4 – 3/4, 1 and 2 in. conn.
Page E4 – 3/8 and 1/2 in. conn.

IDEAL FOR CLEANING:

- Broke chests
- Chemical tanks
- PCB washers
- Pharmaceutical tanks
- Process tanks



PERFORMANCE DATA

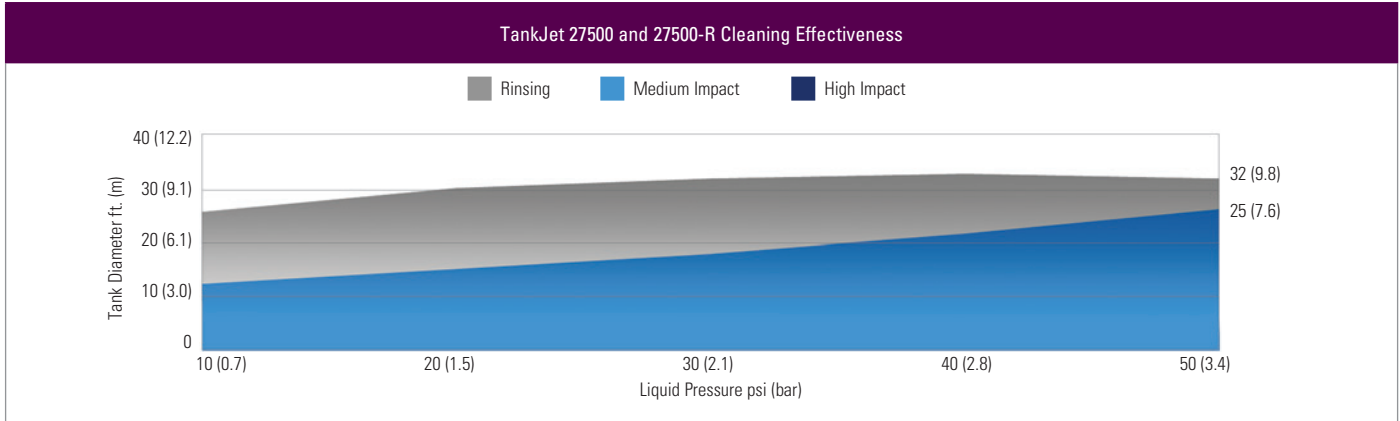

Model 27500		Orifice Dia. in. (mm)	Liquid Flow Capacity gpm (lpm)					Max. Tank Dia. ft. (m)
Inlet Conn. Size	Capacity Size		10 psi (0.7 bar)	20 psi (1.5 bar)	30 psi (2.1 bar)	40 psi (2.8 bar)	50 psi (3.4 bar)	
3	250	0.390 (9.9)	125 (475)	177 (700)	217 (805)	250 (985)	280 (1065)	25 (7.6)
	300	0.422 (10.7)	150 (570)	212 (840)	260 (965)	300 (1180)	335 (1280)	25 (7.6)
	350	0.484 (12.3)	175 (665)	247 (975)	303 (1130)	350 (1380)	391 (1480)	25 (7.6)

Suggested optimum operating range: 20 to 40 psi (1.5 to 2.8 bar).

ADDITIONAL SIZES AVAILABLE

Page D4 – 3/4, 1 and 2 in. conn.
Page E4 – 3/8 and 1/2 in. conn.

ORDERING INFORMATION

TANKJET 27500 TANK CLEANING NOZZLES

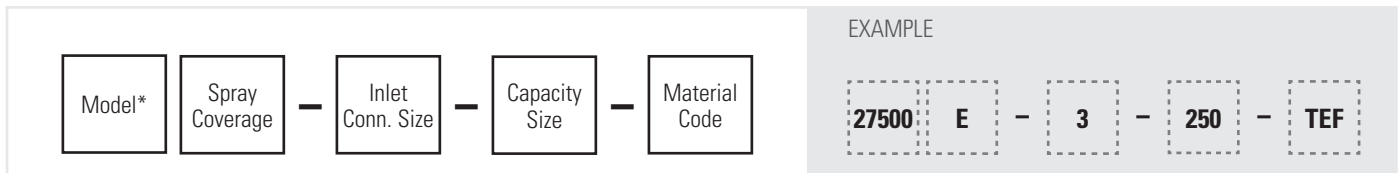

*Add B prior to nozzle size for BSPT connections.